

University of Edinburgh, Main Library, George Square, Edinburgh EH8 9LJ

Revision 14-8-2019

### Twin Infeed AMH Survey Notes

The twin infeed AMH is installed with the infeed units inserted into a wall which is clad with timber.



# Existing AMH Infeed Unit

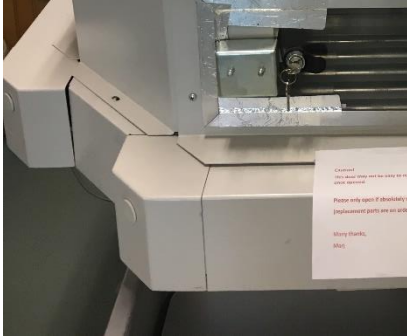
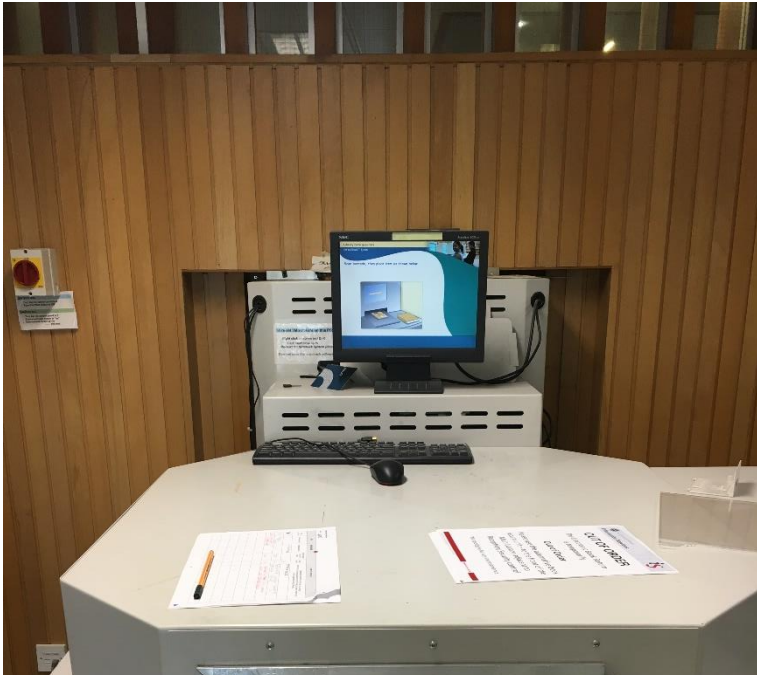

**New AMH Installation – Additional Cut-out Work Required.**

The new AMH infeed units will require pre works to enlarge the opening in the wall to accommodate the new infeed unit as follows. The height of the cut out should measure 1.67m from the floor as the reference point and not from any other existing point or equipment, this will ensure that the height is accurate. The width of the cut-out should be 0.65m and should be positioned so that the centre of each cut out for the infeed is 2.18m apart.

**Plan View.**

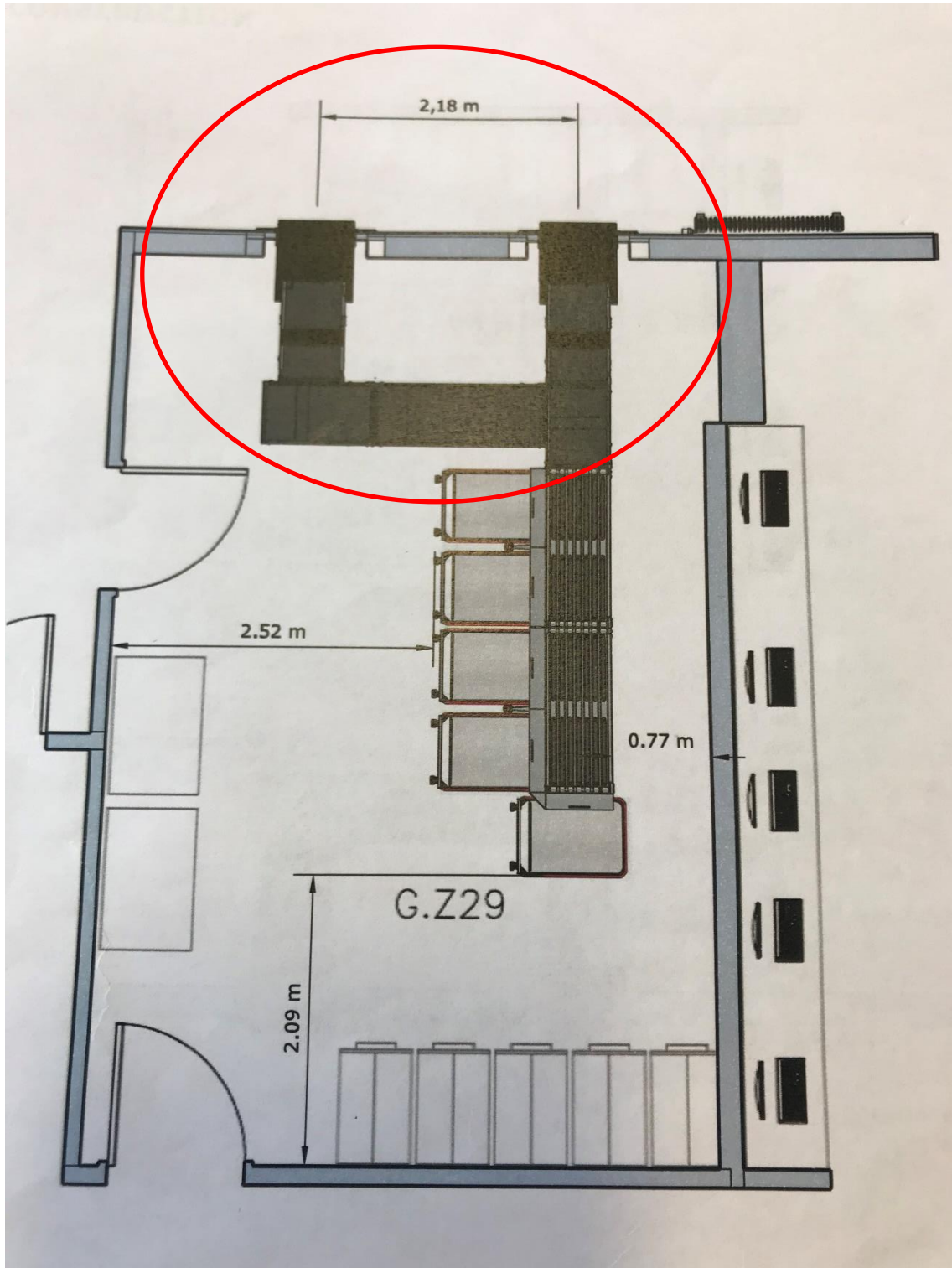



## Front Elevation

The opening in the wall will need to be cut to enlarge the opening to accommodate the new infeed unit which is higher than the current unit.

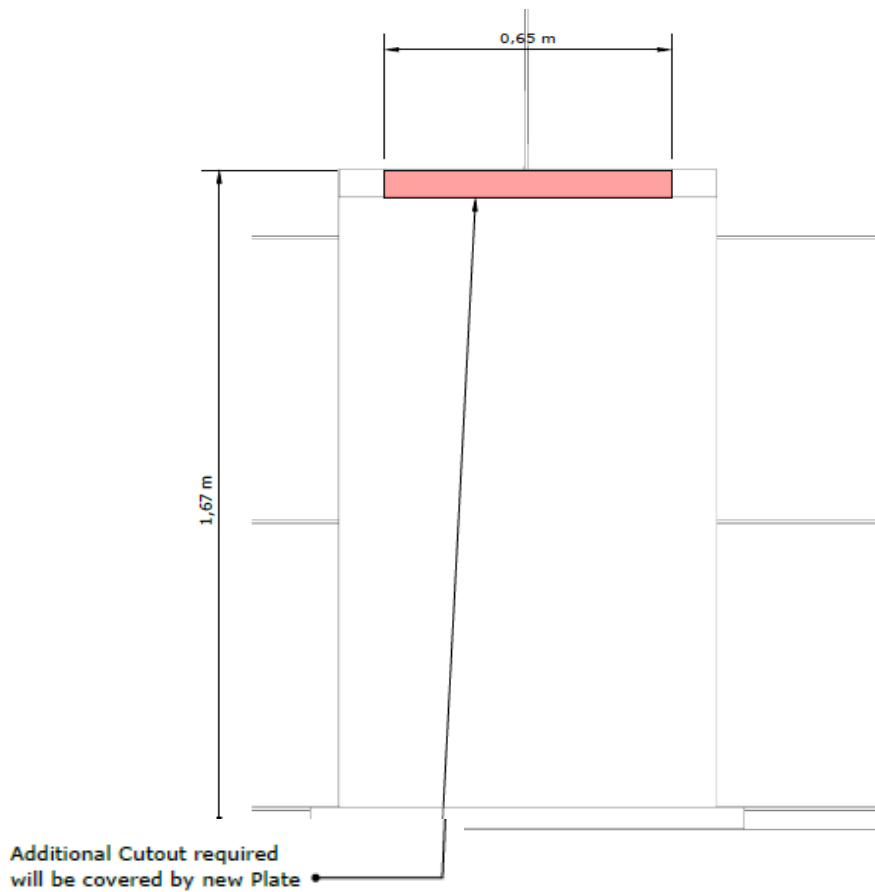
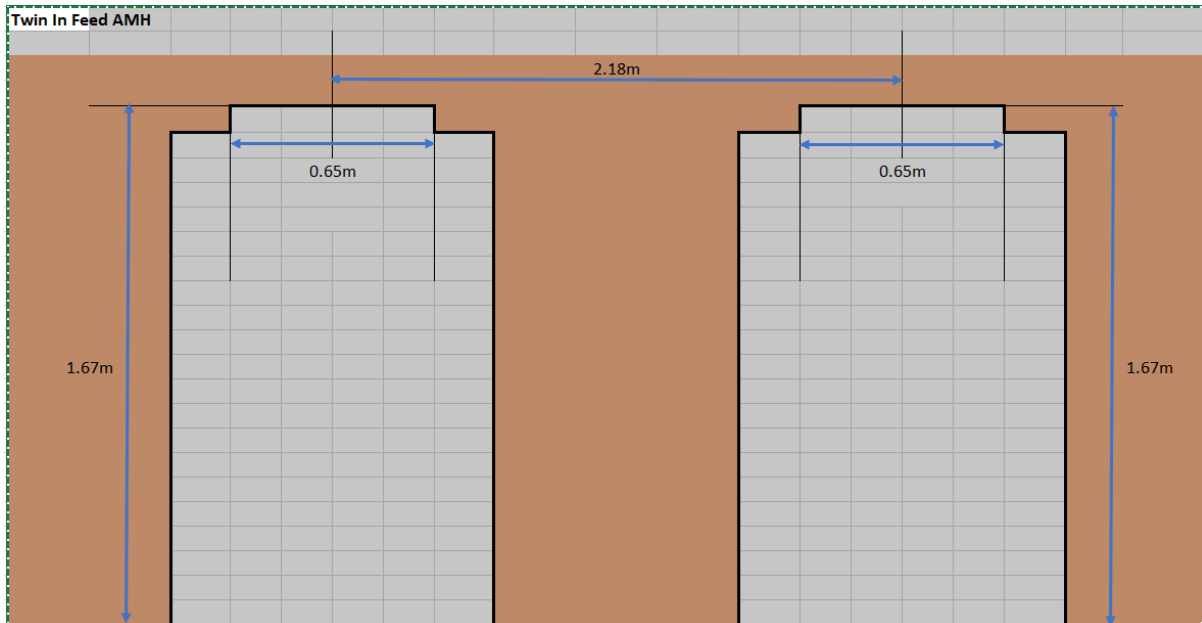

### New Stainless-Steel Front Panel

The new stainless-steel front panel will fit to the front of the new AMH infeed units and a sleeve will insert through the cut-out and into the front panel over the infeed unit giving positioning flexibility and an attractive finish between the two items.

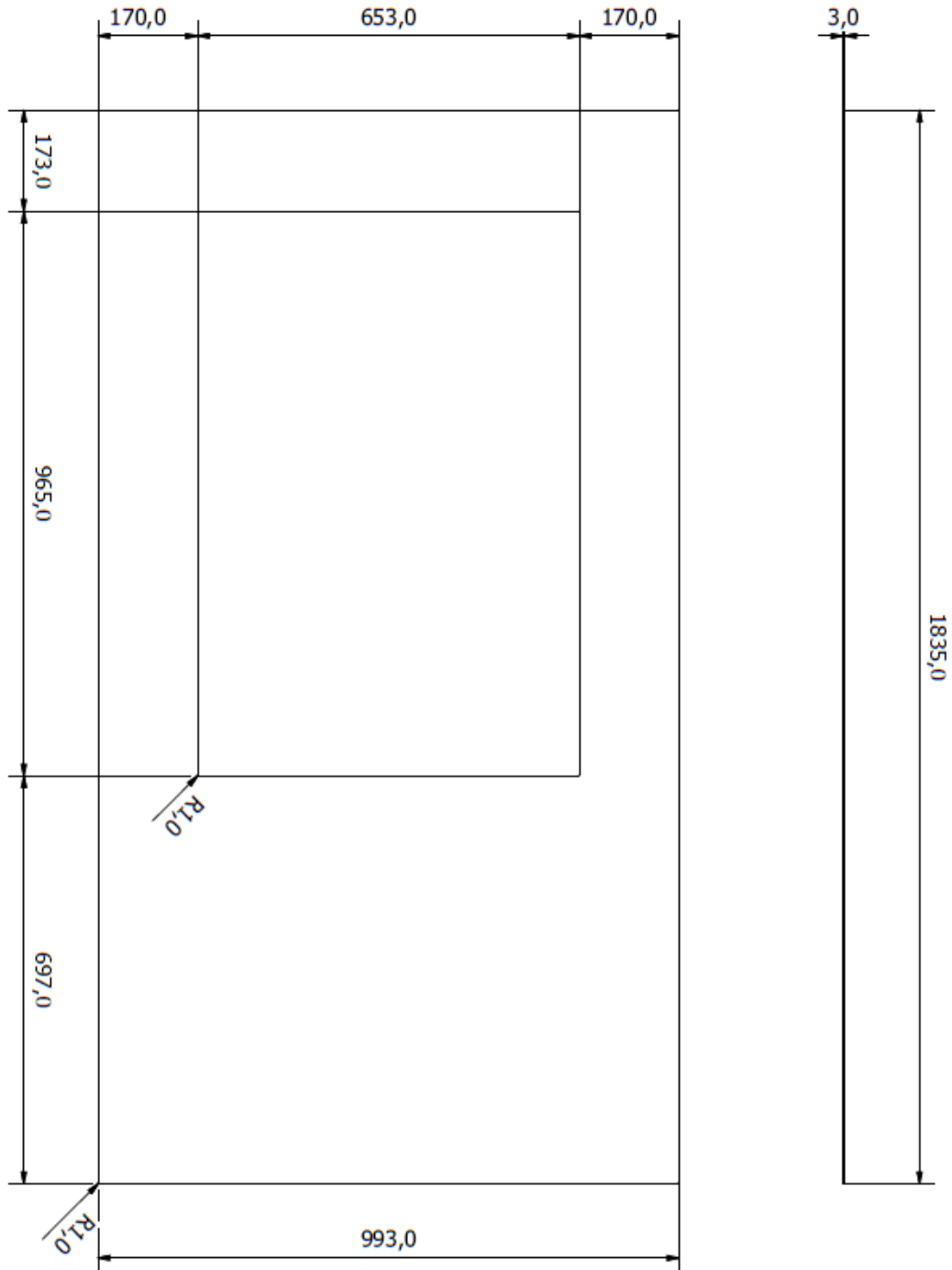

Mounting brackets will be used to mount and secure the stainless-steel front plate to the inside wall edges of the opening in the wall. The bracket positioning can be seen on the drawing below.

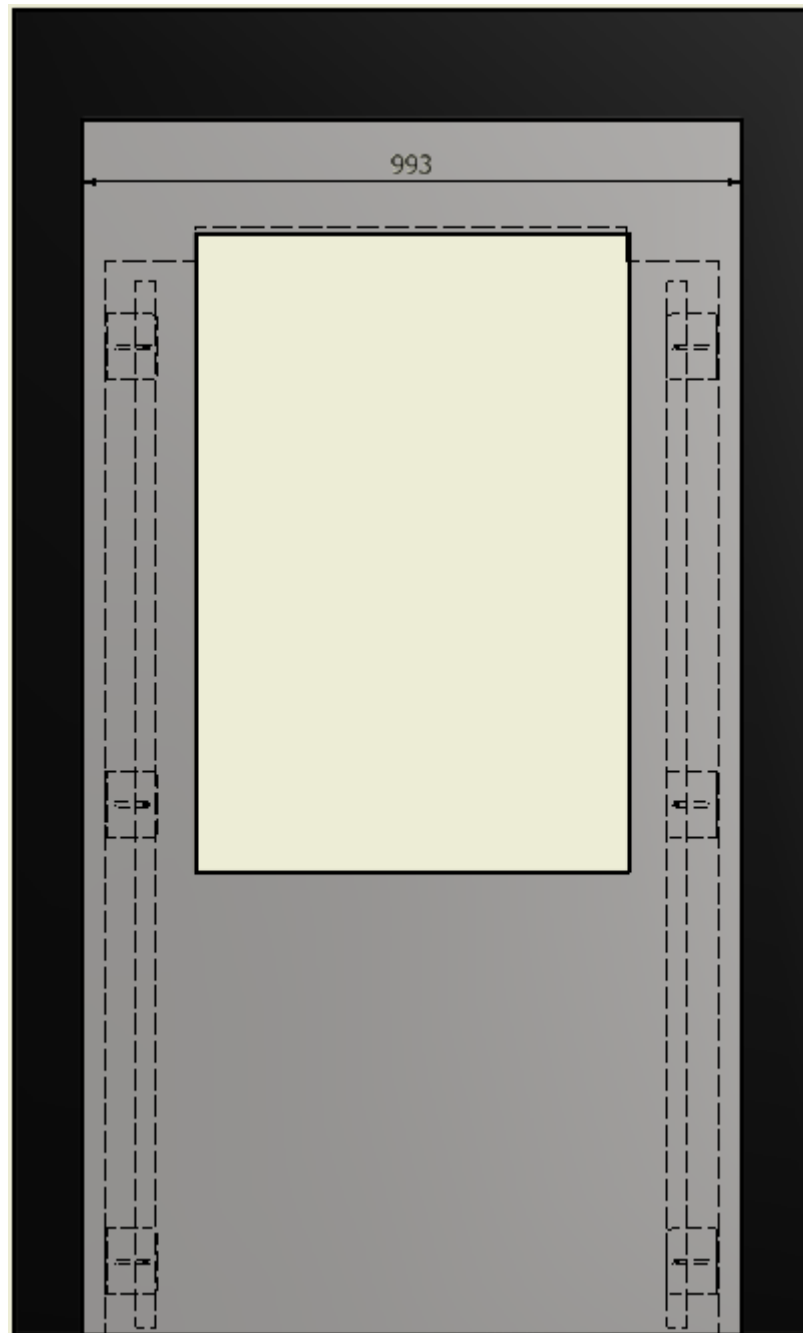

# Power and Data Positioning

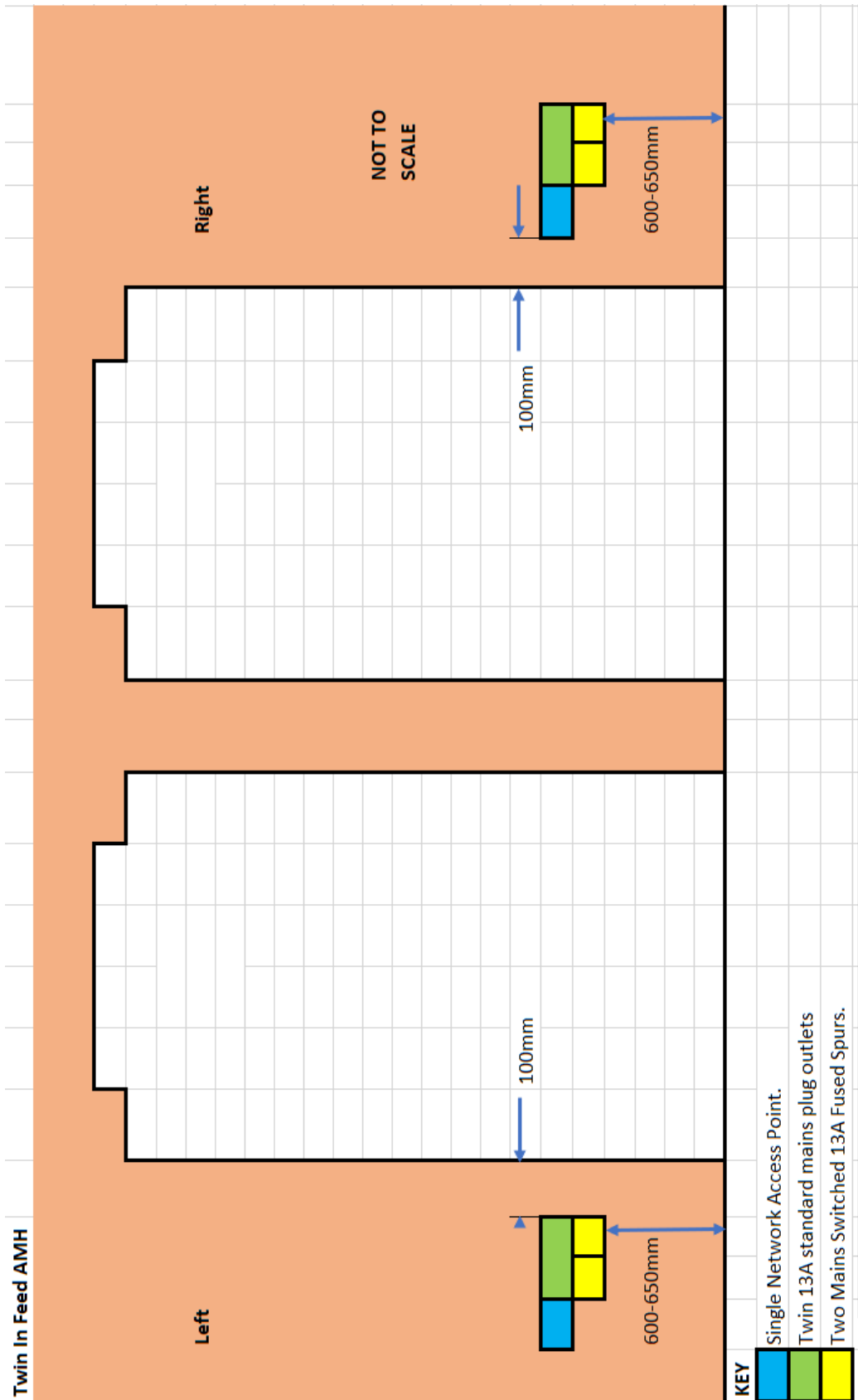

Any questions please ask.